

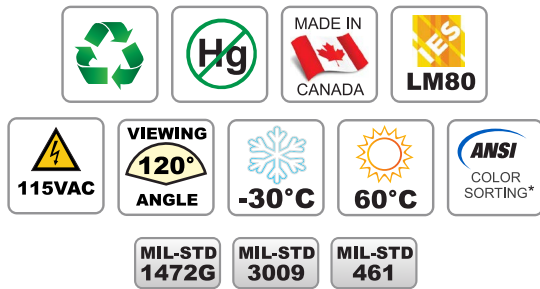

**NSN: 6240-01-655-5877**

**HOW TO ORDER**

DESCRIPTION: LED Replacement Lamp, 18", 4100K  
 ORDER CODE #: FLZ-T12-18

**STANDARD FEATURES**

- 18" length
- 4100K White LEDs
- 115VAC Operating Voltage
- Milk White Lens
- G13 Bi-Pin
- Direct replacement anywhere T12 fluorescent is used (replaces NSN: 6240-00-583-3668)

**NOTES & PATENT INFORMATION**

US Patent #7,307,391 8,115,411 8,791,650 9,179,513  
 Canada Patent #2,651,224 2,255,065 2,831,641  
 International Patents Pending  
 For complete and up to date patent information see our website

\*Starter removed as, per MIL-DTL-16377/86A(SH)

**DESCRIPTION**

The LED lighting tube has been designed to work with conventional MIL-DTL-16377 fluorescent fixtures in order to replace the short lived fluorescent lamps and ballasts that are typically used in interior lighting. The LED tube works with or without a ballast. This lamp is suitable for use in all MIL-DTL-16377/5, /18, /58, /65, /66 fixtures.

**SPECIFICATIONS**

- MIL-DTL-16377J compliant
- Operating Temperature: 77°F (25°C), Range -22°F (-30°C) to 130°F (60°C)
- Power Factor: 0.99
- L80 60,000 Hours (based on TM21)
- Minimum 80 CRI, Typical 85 CRI (based on LM80 and ANSI 78.377-2008)
- Uniform color (based on LM80 and ANSI 78.377-2008)
- MIL-STD-461 Compliant (Navy RE101, RE102, CE101, CE102)
- Anti-Vibration compliant (MIL-STD-167-1A)
- V0 Rated Plastics (Smoke and Toxicity tested)

**FEATURES**

- Solid state lighting device, works well in harsh environments of hot or cold temperatures
- Instant on, no warm up time required
- Lasts 5 times longer than fluorescent
- The extrusion acts as a heat sink to extend life of the LEDs
- Low EMI emissions
- Designed to replace conventional fluorescent lamps
- Lead and mercury free

## ELECTRICAL STATS & OPERATING FUNCTIONS

TYPE	Nominal Length (inch)	Lens Type	TYPE	Input Voltage (AC Volts)			Input Current (Amp)			Luminous Intensity	Power Consumption	CRI
				MIN	TYP	MAX	MIN	TYP	MAX	4100K	TYP	TYP
FLZ	18	MILK WHITE	0-G	100	115	127	0.04	0.09	0.10	976	8	85

## DIMENSIONS

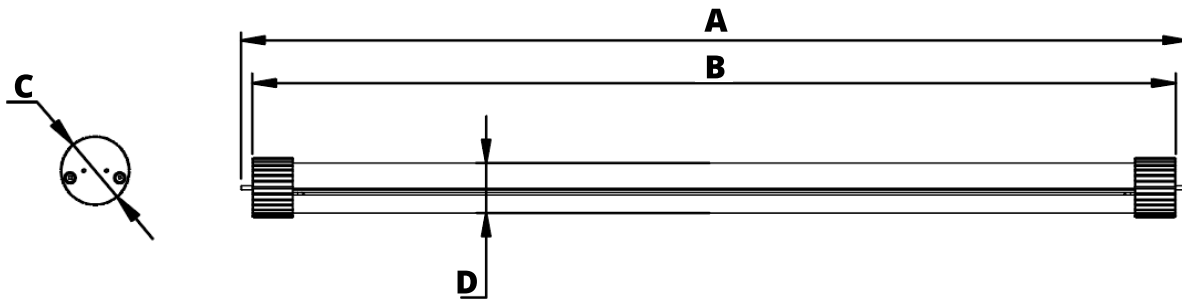

Nominal length	A (pin to pin)		B (end to end)		C (end cap dia)		D (Lamp body dia)	
	INCH	MM	INCH	MM	INCH	MM	INCH	MM
18"	17.71	450	17.12	435	1.49	38	1.25	32

## ORDERING INFORMATION

SERIES	SIZE	END CAP	LENGTH	VOLTAGE	TYPE	WATTAGE	COLOR	LENS
FLZ	T12	G	18	115	0-G	8	41	S